

POWER LOCK SYSTEMS

CONTENTS

	page		page
GENERAL INFORMATION		DOOR MODULE	4
INTRODUCTION	1	POWER LIFTGLASS RELEASE SYSTEM	5
MEMORY SYSTEM	2	POWER LOCK AND REMOTE KEYLESS ENTRY SYSTEM	4
POWER LIFTGLASS RELEASE SYSTEM	1	POWER LOCK MOTOR	5
POWER LOCK SYSTEM	1	REMOTE KEYLESS ENTRY TRANSMITTER ...	5
REMOTE KEYLESS ENTRY SYSTEM	2	SERVICE PROCEDURES	
DESCRIPTION AND OPERATION		REMOTE KEYLESS ENTRY TRANSMITTER	
BODY CONTROL MODULE	3	BATTERY REPLACEMENT	6
CIRCUIT BREAKER	3	REMOTE KEYLESS ENTRY TRANSMITTER	
DOOR MODULE	2	PROGRAMMING	6
POWER LOCK MOTOR	3	REMOVAL AND INSTALLATION	
POWER LOCK SWITCH	2	DOOR MODULE	6
REMOTE KEYLESS ENTRY RECEIVER	4	POWER LOCK MOTOR	7
REMOTE KEYLESS ENTRY TRANSMITTER ...	3		
DIAGNOSIS AND TESTING			
CIRCUIT BREAKER	4		

GENERAL INFORMATION

INTRODUCTION

Power locks and Remote Keyless Entry (RKE) systems are standard factory-installed equipment on these models. All of the doors and the liftgate can be locked and unlocked electrically by operating the switch on either front door trim panel, or the buttons on the RKE transmitter. On vehicles with the optional liftgate liftglass, the power liftglass release circuit is also enabled or disabled by the power door lock switch or the RKE transmitter.

Following are general descriptions of the major components in the power lock, RKE, and liftglass latch systems. Refer to 8W-61 - Power Door Locks in Group 8W - Wiring Diagrams for complete circuit descriptions and diagrams. Refer to the owner's manual for more information on the features and use of these systems.

NOTE: This group covers both Left-Hand Drive (LHD) and Right-Hand Drive (RHD) versions of this model. Whenever required and feasible, the RHD versions of affected vehicle components have been constructed as mirror-image of the LHD versions. While most of the illustrations used in this group represent only the LHD version, the diagnostic and service procedures outlined can generally be applied to either version. Exceptions to this rule have been clearly identified as LHD or RHD, if a special illustration or procedure is required.

POWER LOCK SYSTEM

The power lock system allows all of the doors and the liftgate to be locked or unlocked electrically by operating the switch on either front door trim panel. This system operates with battery power supplied through a circuit breaker in the junction block, independent of the ignition switch.

The power lock system includes the front door power lock switches, door modules mounted in each front door, and the power lock motors mounted in each door and the liftgate.

POWER LIFTGLASS RELEASE SYSTEM

Models equipped with the optional liftgate liftglass feature also have a power operated liftglass release system. This system operates with battery power supplied through a fuse in the junction block, independent of the ignition switch. The power liftglass release system allows the liftglass to be opened by depressing a switch mounted in the top of the liftgate license plate tub.

The liftglass release system includes the liftgate mounted switch, a mechanical latch equipped with an electric release solenoid, and a limit switch integral to the liftgate latch mechanism. The limit switch automatically enables or disables the liftglass release circuitry, depending upon the position of the liftgate latch lock mechanism. The liftgate latch can be unlocked or locked using the key in the liftgate lock cylinder, the power lock system, or the remote keyless entry transmitter.

GENERAL INFORMATION (Continued)

Refer to 8W-61 - Power Door Locks in Group 8W - Wiring Diagrams for circuit descriptions and diagrams. Refer to Group 23 - Body for the power lift-glass release component service procedures.

REMOTE KEYLESS ENTRY SYSTEM

The Remote Keyless Entry (RKE) system is a radio frequency system that allows the use of a remote transmitter to control the power lock and illuminated entry systems. If the vehicle is so equipped, the RKE transmitter can also control the memory seat, memory mirror, memory radio, and the vehicle theft alarm systems.

The RKE system consists of the remote key fob transmitter and a receiver with program logic, which is integral to the passenger door module. The RKE system can retain the vehicle access codes of two transmitters. The transmitter codes are retained in memory, even if the battery is disconnected.

If a transmitter is faulty or lost, new transmitter vehicle access codes can be programmed into the system using a DRB scan tool and the proper Body Diagnostic Procedures manual.

On models so equipped, a function of the RKE system made possible by the connection of the passenger door module to the Chrysler Collision Detection (CCD) data bus network is a panic mode. If the Panic button on the transmitter is depressed, the horn will sound and lights will flash on the vehicle for about three minutes, or until any of the three transmitter buttons is depressed. A vehicle speed of about 24 kilometers-per-hour (15 miles-per-hour) will also cancel the panic mode.

MEMORY SYSTEM

An electronic memory system is an available option on this model. The memory system is able to store and recall the driver power seat positions (including power lumbar and recliner positions) and both outside power mirror positions. For vehicles with a radio connected to the Chrysler Collision Detection (CCD) data bus network, the memory system is also able to store and recall ten radio station presets (including last station tuned) for two drivers. The memory system will automatically return to all of these settings when the corresponding button (Driver 1 or 2) of the memory switch on the driver front door trim panel is depressed, or when the doors are unlocked using the corresponding (Driver 1 or 2) Remote Keyless Entry (RKE) transmitter.

The Driver Door Module (DDM) receives hard-wired input from the memory switch on the driver front door trim panel. The DDM also receives messages on the CCD data bus from the RKE receiver in the Passenger Door Module (PDM) for the memory select function. The DDM processes these inputs and

sends messages to the radio (if the radio is CCD data bus capable), the PDM, and the Memory Seat Module (MSM) on the CCD data bus for memory recall.

The CCD data bus network allows the sharing of sensor information. This helps to reduce wire harness complexity, reduce internal controller hardware, and reduce component sensor current loads. At the same time, this system provides increased reliability, enhanced diagnostics, and allows the addition of many new feature capabilities.

This group covers only the conventional diagnostic procedures for the power lock and RKE system components. For diagnosis of the memory system, use of a DRB scan tool and the proper Body Diagnostic Procedures manual are recommended. For additional information on the features and functions of the memory system, refer to the vehicle owner's manual.

DESCRIPTION AND OPERATION**POWER LOCK SWITCH**

The power locks are controlled by a two-way switch mounted in the trim panel of each front door. Each switch is illuminated by a light-emitting diode when the ignition switch is turned to the On position.

The power lock switches are integral to the Driver Door Module (DDM) or Passenger Door Module (PDM), respectively. The power lock switch provides a lock or unlock signal to the door module circuitry.

The power lock switches and their lamps cannot be repaired. If the switches are damaged or faulty, the entire door module must be replaced.

DOOR MODULE

A Driver Door Module (DDM) and a Passenger Door Module (PDM) are used on this model to control and integrate many of the electronic features and functions on the vehicle. The DDM and PDM communicate with each other, and with other vehicle modules on the Chrysler Collision Detection (CCD) data bus network.

The CCD data bus network allows the sharing of sensor information. This helps to reduce wire harness complexity, internal controller hardware, and component sensor current loads. At the same time, this system provides increased reliability, enhanced diagnostics, and allows the addition of many new feature capabilities.

The DDM circuitry controls the output to the driver front door power lock motor. The PDM circuitry controls the output to the power lock motors for the remaining doors and the liftgate. When a door lock switch is actuated, the door module circuitry for that switch sends a message to the other door module on the CCD data bus to activate the output to the remaining power lock motor(s).

DESCRIPTION AND OPERATION (Continued)

Some of the features and functions of the power lock and Remote Keyless Entry (RKE) systems made possible because of the communication of the door modules on the CCD data bus network include:

- A door-lock inhibit feature which prevents the power lock system from being energized with a door switch if the key is in the ignition and/or the headlamps are on with the driver door open. However, the locks can still be operated manually with a key or energized with the RKE transmitter.

- A rolling door locks feature will automatically lock all of the doors and the liftgate, after the vehicle reaches a speed of about 24 kilometers-per-hour (15 miles-per-hour) or greater. This feature will also lock the doors if a door is opened, then closed again at any speed above 24 kilometers-per-hour (15 miles-per-hour). Rolling door locks is a programmable feature of the power lock system. This feature can be enabled or disabled using the DRB scan tool and the proper Body Diagnostic Procedures manual.

- An RKE system panic mode, on models so equipped. If the Panic button on the RKE transmitter is depressed, the horn will sound and lights will flash on the vehicle for about three minutes, or until any of the three transmitter buttons is depressed. A vehicle speed of about 24 kilometers-per-hour (15 miles-per-hour) will also cancel the panic mode.

- A programmable feature of the RKE system is the enabling or disabling of the horn chirp following the RKE Lock function. This feature can be enabled or disabled using the DRB scan tool and the proper Body Diagnostic Procedures manual.

- Another programmable feature is the enabling or disabling of the RKE system unlocking the driver door only, or all doors upon one depression of the transmitter Unlock button. This feature can be enabled or disabled using the DRB scan tool and the proper Body Diagnostic Procedures manual.

For diagnosis of the DDM, PDM, or the CCD data bus network, refer to the proper Body Diagnostic Procedures manual.

BODY CONTROL MODULE

A Body Control Module (BCM) is used on this model to control and integrate many of the electronic functions and features included on the vehicle. The BCM contains a central processing unit and interfaces with other modules in the vehicle on the Chrysler Collision Detection (CCD) data bus network.

The CCD data bus network allows the sharing of sensor information. This helps to reduce wire harness complexity, reduce internal controller hardware, and reduce component sensor current loads. At the same time, this system provides increased reliability, enhanced diagnostics, and allows the addition of many new feature capabilities.

One of the functions and features that the BCM supports and controls on models so equipped, is the Remote Keyless Entry (RKE) Panic Mode. The BCM receives input from the RKE receiver in the Passenger Door Module (PDM) on the CCD data bus. The programming in the BCM allows it to process the information from this input and send control outputs to the headlamp relay, horn relay, and park lamp relay to accomplish the panic mode functions.

The BCM is mounted under the driver side outboard end of the instrument panel, behind the instrument panel support armature and below the outboard switch pod. Refer to Group 8E - Instrument Panel Systems for the removal and installation procedures. For diagnosis of the BCM or the CCD data bus, refer to the proper Body Diagnostic Procedures manual. The BCM can only be serviced by an authorized electronic repair station. Refer to the latest Warranty Policies and Procedures manual for a current listing of authorized electronic repair stations.

POWER LOCK MOTOR

In the power lock and Remote Keyless Entry (RKE) systems, the locks are actuated by a reversible motor mounted within each door and the liftgate. The driver front door lock motor direction is controlled by the battery and ground feeds from the Driver Door Module (DDM). The remaining door lock motors and the liftgate lock motor are controlled by the battery and ground feeds from the Passenger Door Module (PDM).

The power lock motor cannot be repaired and, if faulty or damaged, the entire motor must be replaced.

CIRCUIT BREAKER

An automatic resetting circuit breaker in the junction block is used to protect the power lock system circuit. The circuit breaker can protect the system from a short circuit, or from an overload condition caused by an obstructed or stuck lock motor, latch, or lock linkage.

The circuit breaker cannot be repaired and, if faulty, it must be replaced.

REMOTE KEYLESS ENTRY TRANSMITTER

The Remote Keyless Entry (RKE) system transmitter is equipped with up to three buttons, labeled Lock, Unlock, and an optional Panic button. It is also equipped with a key ring and is designed to serve as a key fob. The operating range of the transmitter radio signal is up to 7 meters (23 feet) from the RKE receiver.

Each transmitter has a different vehicle access code, which must be programmed into the memory of the RKE receiver in the vehicle in order to operate

DESCRIPTION AND OPERATION (Continued)

the RKE system. In addition, vehicles with the optional memory system must have their access codes programmed in the RKE receiver so that the molded-in numbers "1" or "2" on the back of the transmitter case coincide with the memory "1" and "2" buttons of the memory set switch in the vehicle.

Transmitter programming must be performed with a DRB scan tool. Refer to the proper Body Diagnostic Procedures manual for the transmitter programming procedure.

The transmitter operates on two Duracell DL2016 (or equivalent) batteries. Typical battery life is from one to two years. The transmitter cannot be repaired and, if faulty or damaged, it must be replaced.

REMOTE KEYLESS ENTRY RECEIVER

The Remote Keyless Entry (RKE) receiver is a radio frequency unit contained in the Passenger Door Module (PDM). The PDM also contains the program circuitry for the RKE system. The PDM is located inside the passenger side front door, and is secured to the door trim panel.

The RKE receiver is energized by one of up to three messages from the RKE transmitter; Unlock, Lock, or an optional Panic. The PDM circuitry responds to these messages to lock or unlock the power lock motors that it controls. The PDM circuitry also puts Lock, Unlock, and the optional Panic messages on the Chrysler Collision Detection (CCD) data bus.

These messages will result in the Driver Door Module (DDM) locking or unlocking the driver side front door, and/or the Body Control Module (BCM) initiating the proper Horn Chirp, Illuminated Entry, and Vehicle Theft Alarm functions. If the vehicle is equipped with the optional memory system, the proper CCD Unlock message will also result in the DDM initiating its memory recall functions.

For diagnosis of the RKE receiver, the PDM, the DDM, or the CCD data bus, refer to the proper Body Diagnostic Procedures manual. The RKE receiver is only serviced as a unit with the PDM and, if faulty or damaged, the PDM unit must be replaced.

DIAGNOSIS AND TESTING

POWER LOCK AND REMOTE KEYLESS ENTRY SYSTEM

As a preliminary diagnosis for the power lock and remote keyless entry systems, note the system operation while you actuate both the Lock and Unlock functions with the power lock switches and the remote keyless entry transmitter. Then, proceed as follows:

- If the system fails to function with either the switches or the transmitter, see the Circuit Breaker diagnosis in this group.
- If the system functions with both switches, but not with the transmitter, see the Remote Keyless Entry Transmitter diagnosis in this group.
- If the system functions with the transmitter, but not with one or both switches, see the Door Module diagnosis in this group.
- If one lock motor fails to operate with the switches or the transmitter, see the Power Lock Motor diagnosis in this group.

CIRCUIT BREAKER

For circuit descriptions and diagrams, refer to 8W-61 - Power Door Locks in Group 8W - Wiring Diagrams.

(1) Locate the correct circuit breaker in the junction block. Pull out the circuit breaker slightly, but be sure that the terminals still contact the terminals in the junction block.

(2) Connect the negative lead of a 12-volt DC voltmeter to a good ground.

(3) With the voltmeter positive lead, check both terminals of the circuit breaker for battery voltage.

If only one terminal has battery voltage, the circuit breaker is faulty and must be replaced. If neither terminal has battery voltage, repair the open circuit from the Power Distribution Center (PDC) as required. If the circuit breaker checks OK, but no power locks operate, see the diagnosis for the Door Module in this group.

DOOR MODULE

NOTE: The following tests may not prove conclusive in the diagnosis of this component. The most reliable, efficient, and accurate means to diagnose this system involves the use of a DRB scan tool and the proper Body Diagnostic Procedures manual.

Remember, the DDM circuitry controls the output to the driver side front door power lock motor. The PDM circuitry controls the output to the power lock motors for the remaining doors and the liftgate. For circuit descriptions and diagrams, refer to 8W-61 - Power Door Locks in Group 8W - Wiring Diagrams.

(1) Disconnect and isolate the battery negative cable. Remove the front door trim panel as described in this group. Go to Step 2.

(2) Check the 12-way door module wire harness connector to see that it is fully seated in the door module receptacle. If OK, go to Step 3. If not OK, install the wire harness connector properly.

(3) Unplug the 12-way door module wire harness connector from the door module. Check for continuity

DIAGNOSIS AND TESTING (Continued)

between the ground circuit cavity of the door module wire harness connector and a good ground. There should be continuity. If OK, go to Step 4. If not OK, repair the open circuit as required.

(4) Connect the battery negative cable. Check for battery voltage at the fused B(+) circuit cavity of the 12-way door module wire harness connector. If OK, go to Step 5. If not OK, repair the open circuit as required.

(5) Disconnect and isolate the battery negative cable. Check for continuity between the door lock driver circuit cavity of the 12-way door module wire harness connector and a good ground. Repeat the check for the door unlock driver circuit cavity of the door module wire harness connector. In each case there should be no continuity. If OK, go to Step 6. If not OK, repair the short circuit as required.

(6) Plug the 12-way door module wire harness connector back into the door module. Unplug the inoperative power lock motor wire harness connector. Connect the battery negative cable. Go to Step 7.

(7) Connect the probes of a reversible DC digital voltmeter to the body wire harness half of the power lock motor wire harness connector. Observe the voltmeter while actuating the power lock switch in the lock and unlock directions. There should be a short 12-volt voltage spike as the switch is moved to both the lock and unlock positions, and no voltage in the neutral position. If OK, see the diagnosis for Power Lock Motor in this group. If not OK, replace the faulty door module.

POWER LOCK MOTOR

Remember, the DDM circuitry controls the output to the driver side front door power lock motor. The PDM circuitry controls the output to the power lock motors for the remaining doors and the liftgate. For circuit descriptions and diagrams, refer to 8W-61 - Power Door Locks in Group 8W - Wiring Diagrams.

(1) If only one lock motor is inoperative, go to Step 2. If all lock motors except the driver side front door are inoperative, the problem may be caused by one shorted motor. Unplugging a shorted motor from the power lock circuit will allow the good motors to operate. Unplug each PDM-controlled lock motor wire harness connector, one at a time, and recheck both the lock and unlock functions by operating the power lock switch. If unplugging one motor causes the other motors to become functional, go to Step 2 to test the unplugged motor.

(2) Once it is determined which lock motor is inoperative, that motor can be tested as follows. Unplug the wire harness connector at the inoperative motor. Apply 12 volts to the motor terminals to check its operation in one direction. Reverse the polarity to check the operation in the other direction. If OK,

repair the short or open circuits to the door module as required. If not OK, replace the faulty lock motor.

REMOTE KEYLESS ENTRY TRANSMITTER

(1) Replace the Remote Keyless Entry (RKE) transmitter batteries as described in this group. Test each of the transmitter functions. If OK, discard the faulty batteries. If not OK, go to Step 2.

(2) Perform the Remote Keyless Entry Transmitter Programming procedure with the suspect transmitter and another known good transmitter using a DRB scan tool, as described in the proper Diagnostic Procedures manual.

(3) Test the RKE system operation with both transmitters. If both transmitters fail to operate the power lock system, use a DRB scan tool and the proper Diagnostic Procedures manual for diagnosis of the RKE system. If the known good transmitter operates the power locks and the suspect transmitter does not, replace the faulty transmitter.

NOTE: Be certain to perform the Remote Keyless Entry Transmitter Programming procedure again following this test. This procedure will erase the access code of the test transmitter from the RKE receiver.

POWER LIFTGLASS RELEASE SYSTEM

For circuit descriptions and diagrams, refer to 8W-61 - Power Door Locks in Group 8W - Wiring Diagrams.

(1) Check the fuse in the junction block. If OK, go to Step 2. If not OK, replace the faulty fuse.

(2) Check for battery voltage at the fuse in the junction block. If OK, go to Step 3. If not OK, repair the open circuit as required.

(3) Unplug the liftglass limit switch wire harness connector. Check for battery voltage at the fused B(+) circuit cavity of the limit switch wire harness connector. If OK, go to Step 4. If not OK, repair the open circuit as required.

(4) Check for continuity between the two terminals of the liftglass limit switch. There should be continuity with the liftgate latch unlocked, and no continuity with the latch locked. If OK, go to Step 5. If not OK, replace the faulty limit switch.

(5) Unplug the liftglass push button switch wire harness connector. With the liftgate latch unlocked, check for battery voltage at the liftglass limit switch output circuit cavity of the switch wire harness connector. If OK, go to Step 6. If not OK, repair the open circuit as required.

(6) Check for continuity between the two terminals of the liftglass push button switch. There should be no continuity. Depress the switch, there should now

DIAGNOSIS AND TESTING (Continued)

be continuity. If OK, go to Step 7. If not OK, replace the faulty push button switch.

(7) Unplug the liftglass release solenoid wire harness connector. Check for continuity between the ground circuit cavity of the wire harness connector and a good ground. There should be continuity. If OK, go to Step 8. If not OK, repair the open circuit as required.

(8) With the liftgate latch unlocked and the liftglass push button switch depressed, check for battery voltage at the liftglass push button output circuit cavity of the liftglass release solenoid wire harness connector. If OK, replace the faulty solenoid. If not OK, repair the open circuit as required.

SERVICE PROCEDURES

REMOTE KEYLESS ENTRY TRANSMITTER BATTERY REPLACEMENT

To replace the Remote Keyless Entry (RKE) transmitter batteries, separate the transmitter case halves at the center seam by prying gently with a trim stick, or other suitable wide, flat-bladed tool. The case snaps open and shut.

Replace the two batteries with new Duracell DL2016, or their equivalent. Be certain that the batteries are installed with their polarity correctly oriented. Then, align the two transmitter case halves with each other, and squeeze them firmly together until they snap back into place.

REMOTE KEYLESS ENTRY TRANSMITTER PROGRAMMING

To program the Remote Keyless Entry (RKE) transmitter access codes into the RKE receiver in the passenger door module requires the use of a DRB scan tool. Refer to the proper Body Diagnostic Procedures manual for more information.

REMOVAL AND INSTALLATION

DOOR MODULE

(1) Disconnect and isolate the battery negative cable.

(2) Remove the bezel near the inside door latch release handle by inserting a straight-bladed screwdriver in the notched end and prying gently upwards.

(3) Remove the door trim panel mounting screw located in the bezel opening near the inside door latch release handle (Fig. 1).

(4) Remove the trim cap and screw near the rear of the door armrest.

(5) Remove the trim cap and screw at the upper front corner of the trim panel.

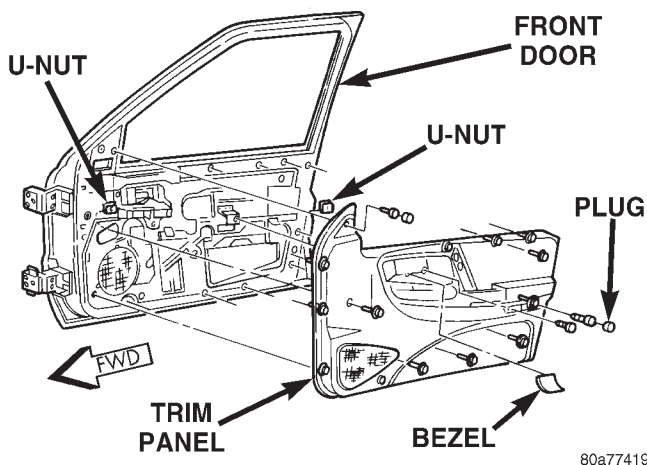

80a77419

Fig. 1 Front Door Trim Panel Remove/Install

(6) Remove the screw located above the front door speaker grille.

(7) Using a wide flat-bladed tool such as a trim stick, pry the trim panel away from the door around the perimeter and remove the trim panel.

NOTE: To aid in the removal of the trim panel, start at the bottom of the panel.

(8) Unplug the wire harness connectors from the door module and the door courtesy lamp, if equipped.

(9) Remove the five screws that secure the door module to the door trim panel (Fig. 2).

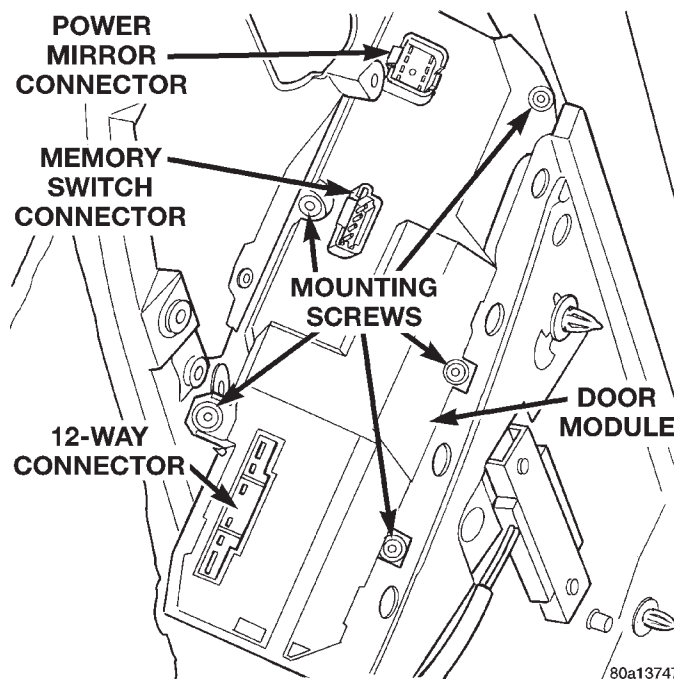

80a13747

Fig. 2 Door Module Remove/Install

(10) Remove the door module from the trim panel.

(11) Reverse the removal procedures to install.

REMOVAL AND INSTALLATION (Continued)

NOTE: If a new door module is installed, the programmable features must be enabled and/or disabled to the customer's preferred settings. Use a DRB scan tool and the proper Body Diagnostic Procedures manual to perform these operations.

POWER LOCK MOTOR

FRONT DOOR

- (1) Remove the front door trim panel as described under Door Module in this group.
- (2) Pull back the watershield from the rear access holes of the inner door panel.
- (3) Remove the screws that secure the power lock motor and latch assembly to the door (Fig. 3).

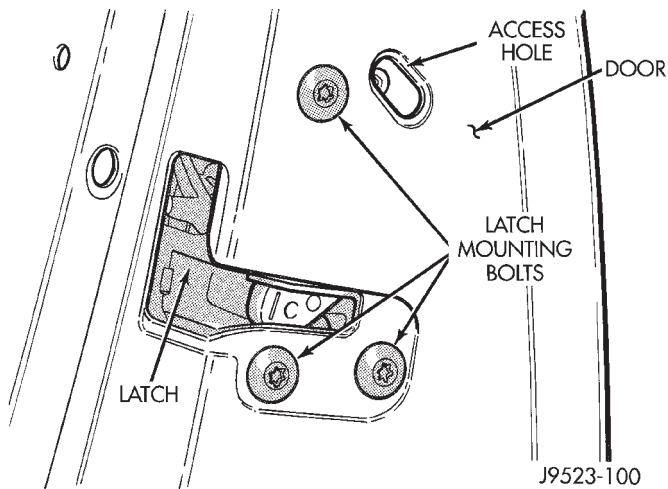

Fig. 3 Door Latch Remove/Install

- (4) Disconnect all of the latch linkage rods from the door latch (Fig. 4).

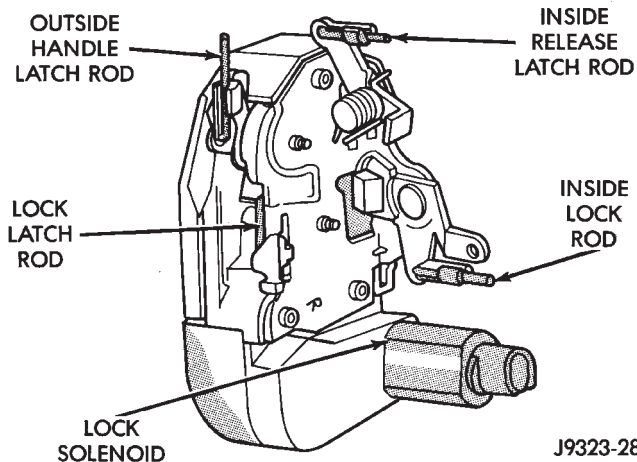

Fig. 4 Door Latch

- (5) Pull the power lock motor and latch out from the door far enough to unplug the wire harness connector.

- (6) Remove the power lock motor and latch assembly from the door.

- (7) Reverse the removal procedures to install. Tighten the power lock motor and latch screws to 10 N·m (95 in. lbs.).

REAR DOOR

- (1) Disconnect and isolate the battery negative cable.

- (2) Remove the bezel near the inside door latch release handle by inserting a straight-bladed screwdriver in the notched end and prying gently upwards.

- (3) Remove the door trim panel mounting screw located in the bezel opening near the inside door latch release handle (Fig. 5).

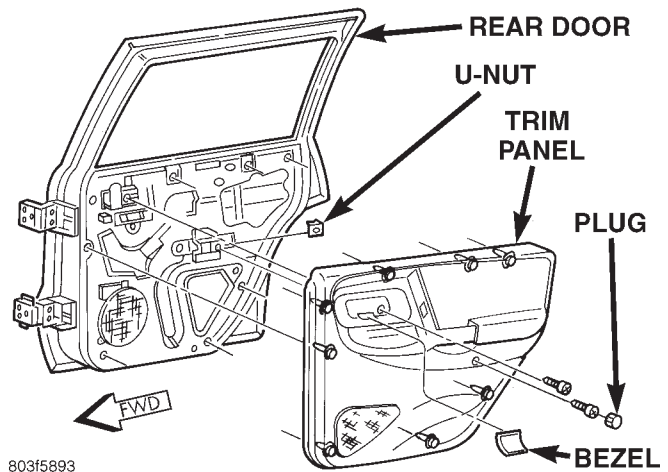

Fig. 5 Rear Door Trim Panel Remove/Install

- (4) Remove the trim cap and screw near the rear of the door armrest.

- (5) Using a wide flat-bladed tool such as a trim stick, pry the trim panel away from the door around the perimeter and remove the trim panel.

NOTE: To aid in the removal of the trim panel, start at the bottom of the panel.

- (6) Unplug the wire harness connector from the door power window switch.

- (7) Pull back the watershield from the rear access holes of the inner door panel.

- (8) Remove the screws that secure the power lock motor and latch assembly to the door (Fig. 6).

- (9) Disconnect all of the latch linkage rods from the door latch.

- (10) Pull the power lock motor and latch out from the door far enough to unplug the wire harness connector.

- (11) Remove the power lock motor and latch assembly from the door.

REMOVAL AND INSTALLATION (Continued)

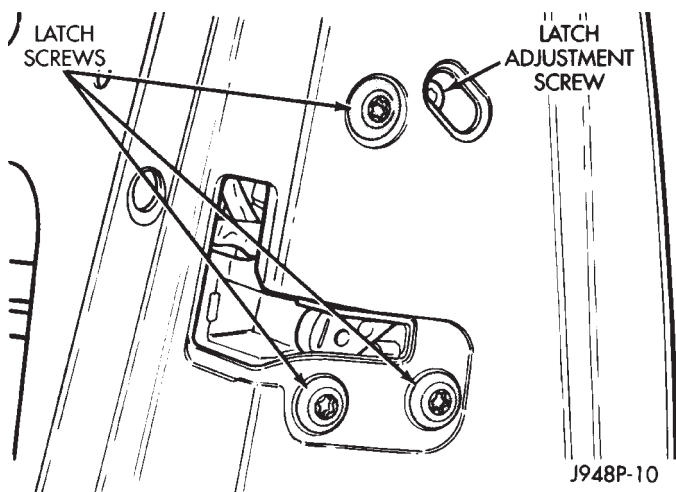
**Fig. 6 Door Latch Remove/Install - Typical**

(12) Reverse the removal procedures to install. Tighten the power lock motor and latch screws to 10 N·m (95 in. lbs.).

LIFTGATE

(1) Disconnect and isolate the battery negative cable.

(2) Remove the screws that secure the liftgate lower trim panel to the liftgate (Fig. 7).

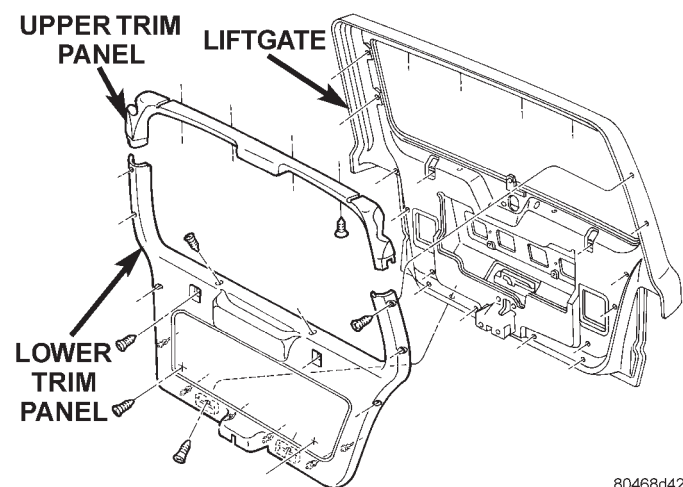
**Fig. 7 Liftgate Trim Panel Remove/Install**

(3) Using a wide flat-bladed tool such as a trim stick, pry the trim panel away from the liftgate around the perimeter and remove the trim panel.

NOTE: To aid in the removal of the trim panel, start at the bottom of the panel.

(4) Disconnect the lock actuator motor linkage clip at the liftgate latch handle (Fig. 8).

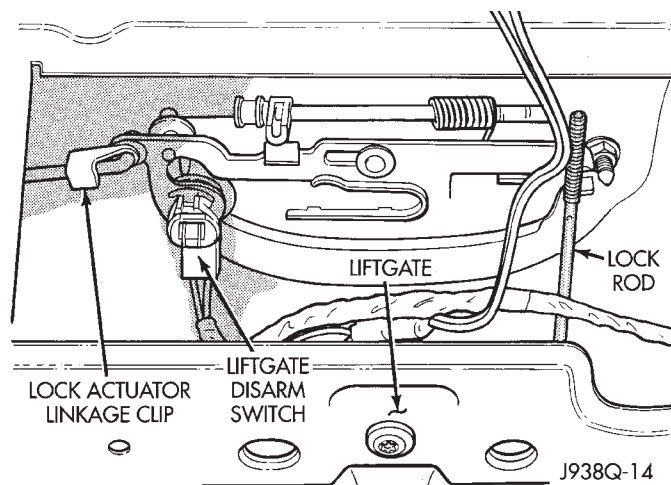
**Fig. 8 Lock Actuator Motor Linkage Remove/Install**

(5) Remove the two screws that secure the lock actuator motor to the liftgate (Fig. 9).

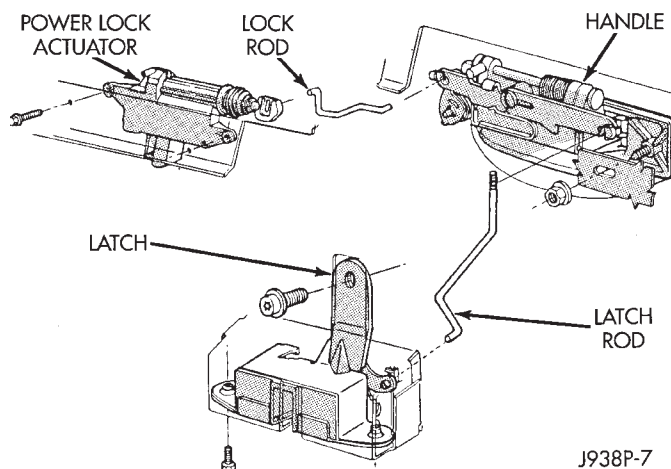
**Fig. 9 Liftgate Lock Motor Remove/Install**

(6) Unplug the wire harness connector from the actuator motor.

(7) Remove the motor from the liftgate.

(8) Reverse the removal procedures to install. Tighten the actuator motor mounting screws to 3 N·m (28 in. lbs.).